

Addendum

Title: Excalibur™ Multirate DAP Addendum
Part/Document Number: 15D09B4-35/C
Date: November, 1996

Supplement to: Excalibur Multirate DAP Installation and Operation Manual
Part/Document Number: 15D09B-1/D
Date: June, 1995

Manual Changes

All standalone Excalibur™ Multirate DAP models come with a new Aggregate card (Part No. 15P09BA) and a new rear panel. Make the following changes to your copy of the Installation and Operation Manual to incorporate the enhanced features provided by these parts.

Page

Change

1-11 The “Dual Interface” section should now be located under “Standard Features” rather than “Options” since all standalone models are now equipped with a dual interface connection. Replace the paragraph under the “Dual Interface” section with the following:

The standalone Excalibur Multirate DAP provides a V.35 interface connection in addition to the standard RS-232-E connection. Simply select the V.35 option from the front panel and connect to the V.35 adapter instead of the RS-232-E connector.

3-2 Replace Figure 3-1 with the following:

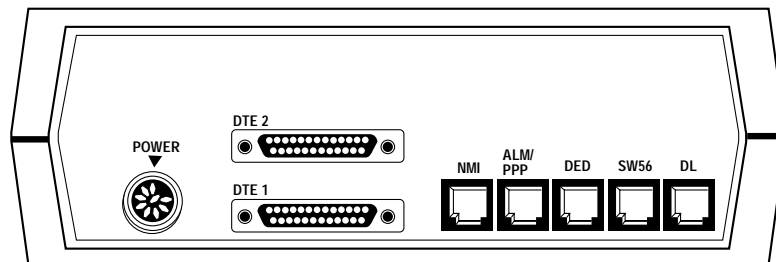

Figure 3-1. Excalibur Multirate DAP Rear Panel

Page

Change

3-2

Replace the description in the “Connecting to the DTE” section with the following:

The Excalibur Multirate DAP provides two DB25S female connectors, labeled **DTE 1** (RS-232-E) and **DTE 2** (V.35), for connecting to the DTE. The correct interface connector, and cable or adapter to use depends on the interface selected:

- **RS-232-E** - Use a standard EIA-232-E cable (25-pin male to 25-pin female) to make this connection. This cable is typically supplied with the DTE. To connect to the DTE, plug the male end of the cable into DAP connector labeled **DTE 1** and plug the female end into the DTE. Figure 3-2 illustrates this connection. Table 3-1 lists the pin/signal assignments for the **DTE 1** connector.
- **V.35** - Use Adapter Part No. 27C522-02 (25-pin male to 34-pin female) to make this connection. This adapter is provided with the DAP and must be installed on the connector labeled **DTE 2**. Use a standard V.35 cable (34-pin male to 34-pin female) to make this connection. This cable is typically supplied with the DTE. To connect to the DTE, plug the male end of the cable into the adapter and plug the female end into the DTE. Figure 3-3 illustrates this connection. Table 3-2 lists the pin/signal assignments for the **DTE 2** connector.

Notes: The interface must be selected manually through the DAP’s front panel. To do so, press the buttons beneath Local/Config/DAP/Intrf. Then press the button beneath V.35 or RS232.

Only one interface can be active at a time.

3-3 Replace Figures 3-2 and 3-3 with the following:

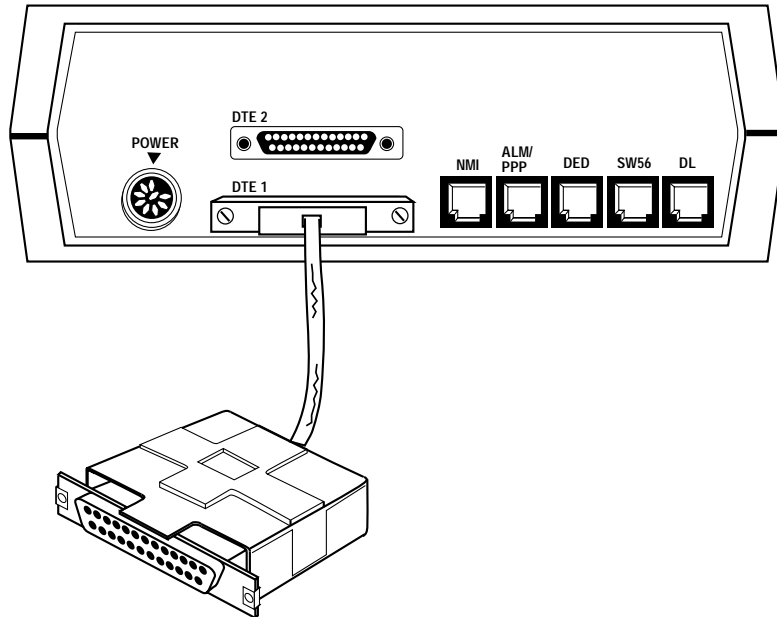

Figure 3-2. RS-232 DTE Connection

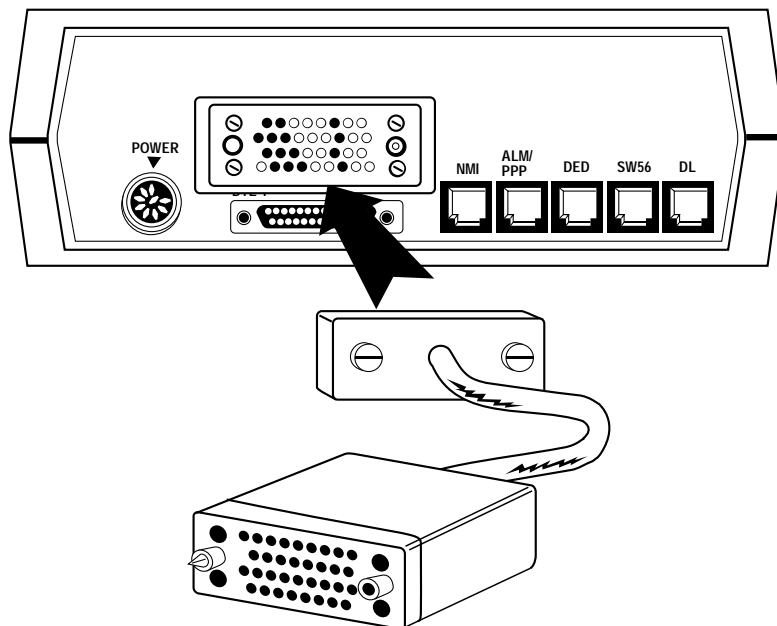

Figure 3-3. V.35 DTE Connection

3-7 Replace Figure 3-4 with the following:

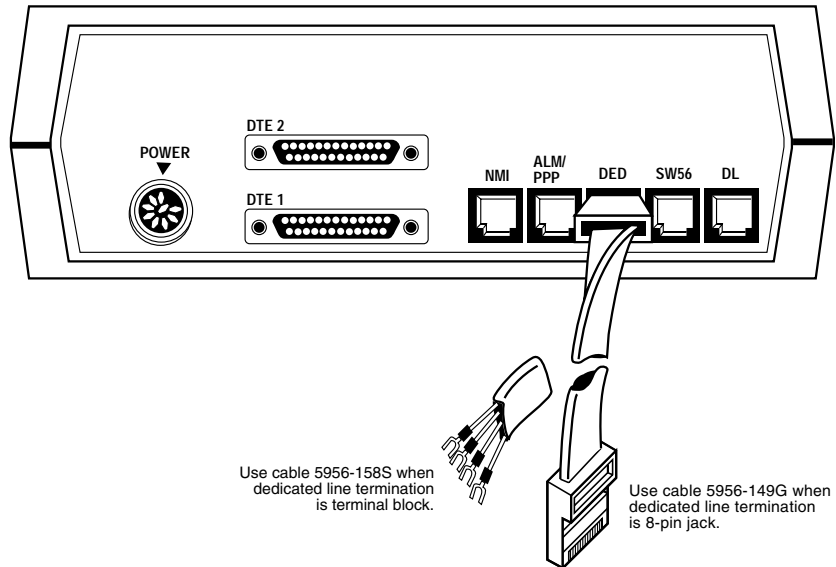

Figure 3-4. Dedicated Line Connection

3-9 Replace Figure 3-5 with the following:

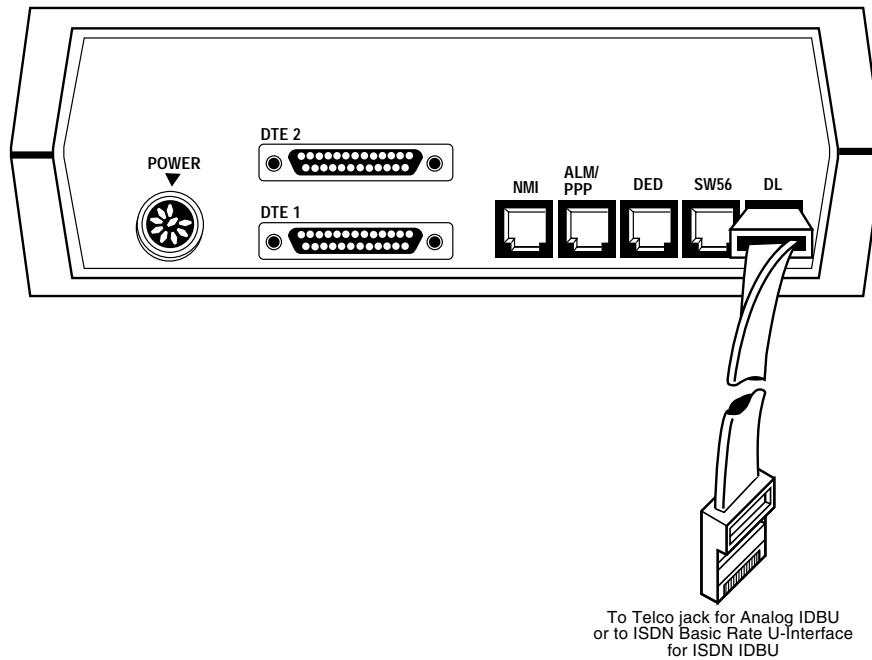

Figure 3-5. Analog or ISDN Dial Line Cable Connection

Page

Change

3-11 Replace Figure 3-6 with the following:

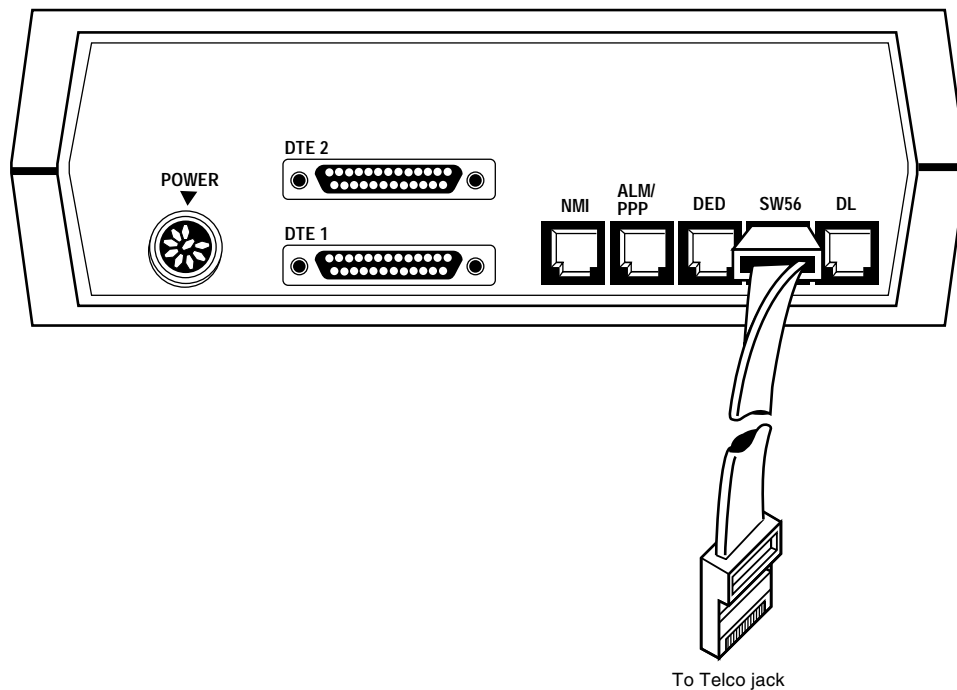

Figure 3-6. Switched 56 Dial Line Cable Connection

3-14 Replace the paragraphs under the “Connecting to an External Alarm” section with the following:

The **ALM/PPP** connector on standalone models or the **EXT ALM** connector on central site models can be used to connect to an external alarm device (such as a burglar alarm or smoke detector). This enables an alarm device at a remote site to transmit an alarm through the secondary channel back to the central site.

To make this connection, you must order Cable Part No. 5956-149V from Milgo. One end of this cable has a 10-pin connector that plugs into the **ALM/PPP** or **EXT ALM** jack. The other end of this cable must be fitted with a connector appropriate to the alarm device at the time of installation. Table 3-9 lists the pin/signal assignments for this connector. (The leftmost pin is designated pin 1.)

Page

Change

3-15 Replace Table 3-9 with the following:

Table 3-9. External Alarm Connector, Pin/Signal Assignments

Pin No.	Signal	Input/ Output	Function
1	Not Used	–	–
2	Not Used	–	–
3	External Alarm	Input	A low true (0V) external alarm.
4	Ground	–	Signal ground.
5	Not Used	–	–
6	Not Used	–	–
7	Not Used	–	–
8	Not Used	–	–
9	Not Used	–	–
10	Not Used	–	–

3-16 Delete the second sentence in the first paragraph.

Page

Change

3-17 Delete the first paragraph and the Note and replace Figure 3-8 with the following:

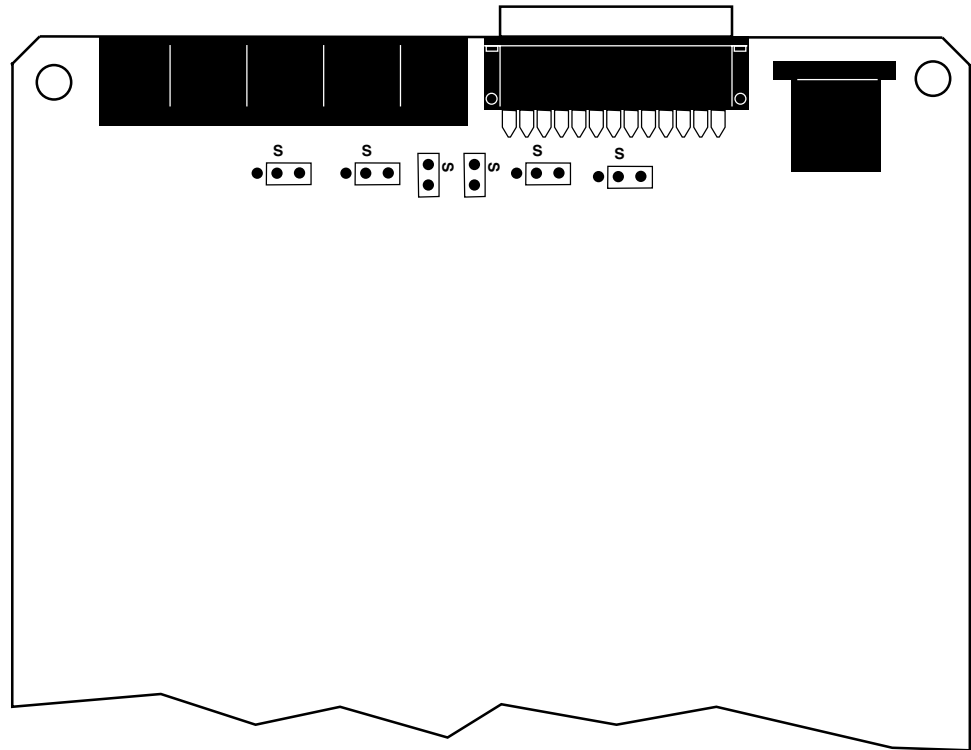

Figure 3-8. Jumper Locations

3-16 Replace Figure 3-11 with the following:

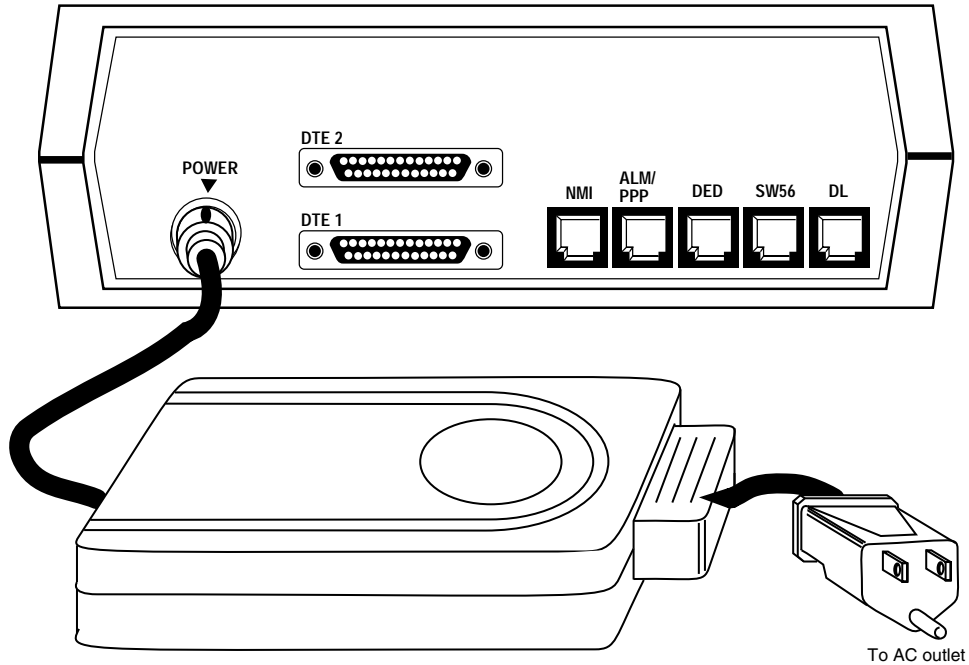

Figure 3-11. Power Supply Connection

3-25 Replace the Caution with the following:



Caution: For use with Power Supply Part No. 25C168-01 or 25C188-01.

Pour utiliser avec alimentation.

5-18 Replace the paragraph in the “Interface” section with the following:

This parameter specifies whether the RS-232-E or V.35 interface is used. When the V.35 interface is used on standalone models, the corresponding adapter must be connected to the **DTE 2** connector located on the rear panel.